

DIGITAL OUTSIDE POINT CALIPER

134

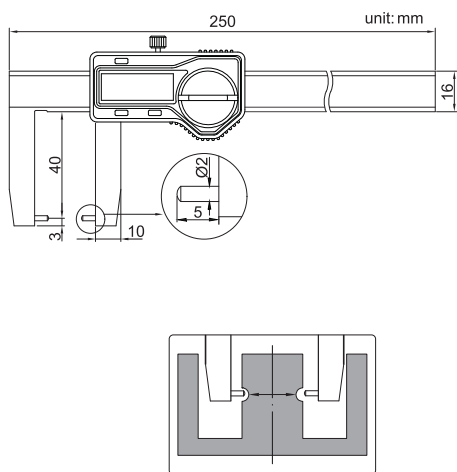
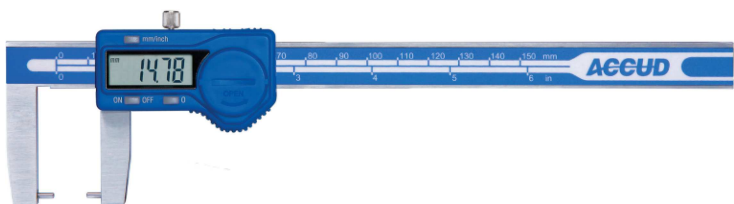
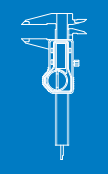

- ◆ Measure wall thickness of inside bores and recesses
- ◆ Resolution: 0.01mm/0.0005"
- ◆ Automatic power on/off
- ◆ Buttons: on/off, zero, mm/inch
- ◆ Data output (cable code:100-11or 100-12)
- ◆ Made of stainless steel

Code	Range	Accuracy
134-006-11	0-150mm/0-6"	±0.04mm

OUTSIDE POINT VERNIER CALIPER

SERIES 144



144-006-11

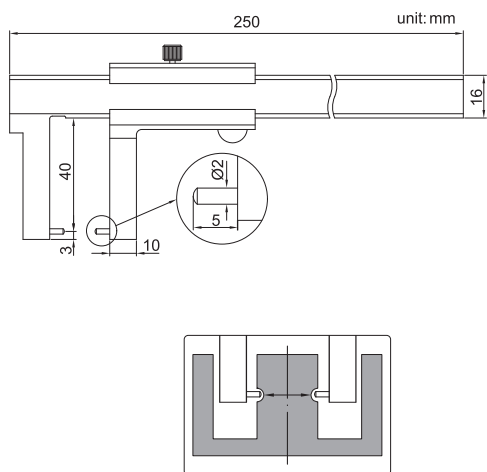

- ◆ Measure wall thickness of inside bores and recesses
- ◆ Made of stainless steel
- ◆ Satin chrome plated reading surface

Code	Range	Graduation	Accuracy
144-006-11	0-150mm	0.02mm	±0.04mm
144-006-13	0-150mm	0.05mm	±0.05mm