

811

PROTRACTOR

- ◆ Graduation: 1°
- ◆ Made of stainless steel
- ◆ Satin chrome plated scale
- ◆ With locking screw



811-180-01

unit: mm

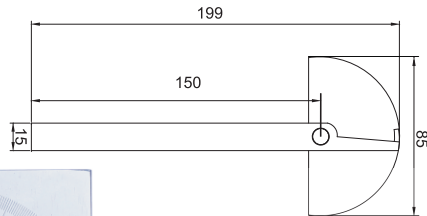

811-180-02

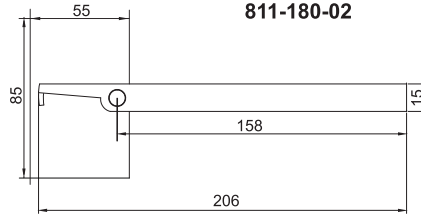

Code	Size	Range	Accuracy
811-180-01	85x150mm	0 - 180°	±0.3°
811-180-02	85x158mm	0 - 180°	±0.3°

SERIES 812

PROTRACTOR

- ◆ Graduation: 1°
- ◆ Satin chrome plated scale
- ◆ With locking screw



812-003-01

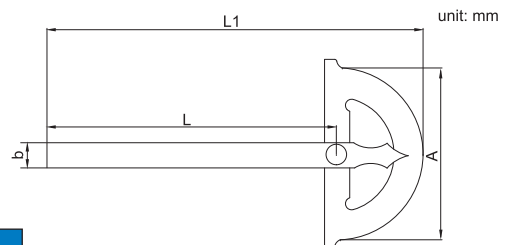

Code	Size(AxL)	Range	Accuracy	b	L1
812-003-01	80x120mm	0 - 180°	±0.3°	11	165
812-005-01	120x150mm	0 - 180°	±0.3°	14	220
812-006-01	150x200mm	0 - 180°	±0.3°	16	285
812-008-01	200x300mm	0 - 180°	±0.3°	20	413
812-012-01	300x500mm	0 - 180°	±0.3°	30	675